

42×11cm

Universal Remote Control  
JJ-RC-SM24-LT  
User Manual

Package Content



LED and Button Rules

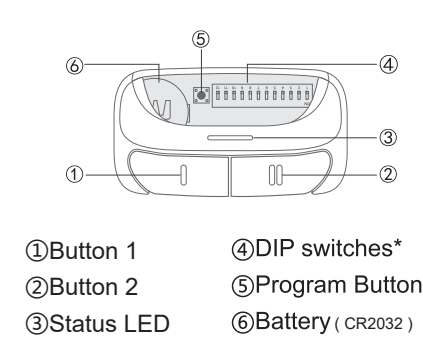

**Note:**  
If your existing garage opener/ remote/ radio receiver uses DIP switch settings, please go to page 6.  
If your existing garage opener/ remote/radio receiver uses Learn Button settings, please go to page 3.

Configuration Guide  
For Learn Button ONLY

1. Start with your garage door, villa door or commercial door closed.
2. Remove the battery cover. Press and hold the Program Button until the status LED lights solid blue to entering into configuration mode. This mode will last 1 min.

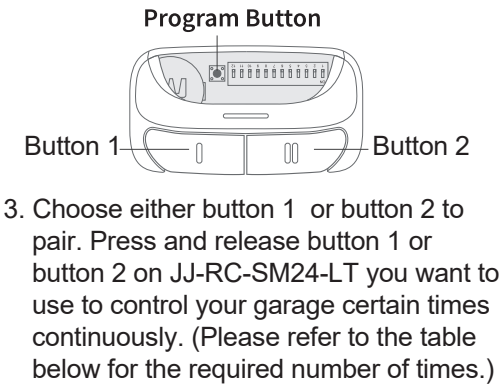

Then you press again the Program Button to store the setting.  
**The required times of button presses varies by different door brands/types, please refer to the below table.**

Times	Brand	Type/Learn Button
1 time	Linear	MegaCode 1997-Current 318MHz
2 times	Chamberlain Liftmaster Craftsman	Orange/Red Button 1997-2005 390MHz
3 times	Chamberlain Liftmaster Craftsman	Purple Button 2005-Current 315MHz
4 times	Chamberlain Liftmaster Craftsman	Green Button 1993-1996 390MHz
5 times	Genie/ Overhead Door	Intellicode I 2005-Current 315MHz
6 times	Genie/ Overhead Door	Intellicode I 1995-Current 390MHz
19 times	Genie/ Overhead Door	Intellicode II 2010-Current 315/390MHz

7 times	Stanley	Security Code 1998-Current 310MHz
8 times	Chamberlain Liftmaster Craftsman	Yellow Button 2011-Current 310/315/390MHz
9 times	Wayne Dalton	Rolling Code1999-Current 372.5MHz

**Note:** For Access Master, Do-It, Gatheron, LiftMaster, Link Control, Sears Craftsman, Master Mechanic, Raynor, Steel Craft, True Value brand, please refer to the programming method of Chamberlain.  
4. You take ladder out and climb to press and release the Learn Button of your garage door motor, then you press again the remote button of JJ-RC-SM24-LT that you set with the correct brand within 30 seconds.

5. Press the program button once to exit the configuration steps. You can use the configured button to control your door now. If your door does not response, please reconfigure the button once more. If it still fails, please contact us for further help.

For DIP Switch ONLY

1. Start with your garage door, villa door or commercial door closed.
2. Match the positions from the JJ-RC-SM24-LT with the DIP switches on your existing garage opener/remote/ radio receiver.

3. If your existing garage opener/remote/ radio receiver has less than 12 switches, for instance 10 switches, please match switch 1 to 10 in JJ-RC-SM24-LT only and keep the rest switches in default “-” positions.

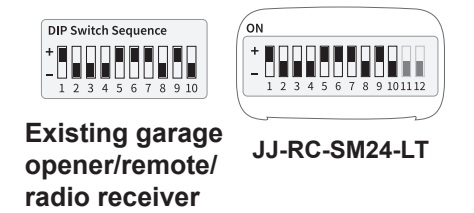

4. Each switch of the JJ-RC-SM24-LT only has 2 positions, if your existing garage opener/radio receiver has 3 positions, you can set them in “+” or “-” first, do not use “0” position. Then match your JJ-RC-SM24-LT again.

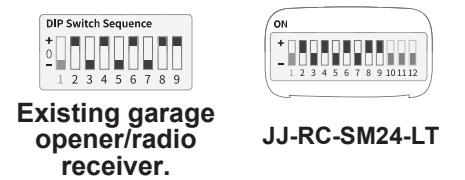

**Existing garage opener/radio receiver.**  
\* For No.15 Stanley Multi-Code with 10 Code switch remote, you must reverse the order of each DIP switch position in our JJ-RC-SM24-LT universal remote to the original remote. If you pair the DIP switch of universal remote control to be same order as the DIP switch of original remote, it will not work for this Stanley Multi-Code brand, the order of DIP switch in universal remote must be reversed.

5. Remove the battery cover. Press and hold the program button until the status LED lights solid blue to entering into configuration mode. This mode will last 1 min.

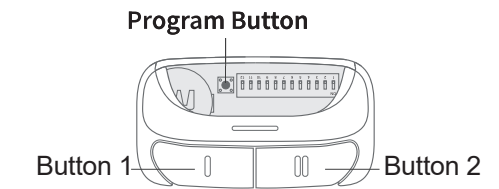

6. Choose either button 1 or button 2 to pair. Press the chosen button and the status LED will flash. When the status LED stops flash, you can then press that button next time, repeat this process multiple times. The required times of button presses varies by different door brands/types.

Times	Brand	Type/DIP Switch
10 times	Chamberlain Liftmaster Craftsman	9 Code Switch 1990-1992 390MHz
11 times	Chamberlain Liftmaster Craftsman	9 Code Switch 1983-1989 315MHz
12 times	Genie	12 Code Switch 1985 390MHz
13 times	Linear Multi-Code	10 Code Switch 300MHz
14 times	Chamberlain Liftmaster Craftsman	8 Code Switch 390MHz
15 times	Stanley Multi-Code	10 Code Switch 310MHz
16 times	Genie	9 Code Switch 390MHz
17 times	Linear Moor-O-Matic	8 Code Switch 310MHz
18 times	Chamberlain Liftmaster Craftsman	7 Code Switch 390MHz

**Note:** For Access Master, Do-It, Gatheron, LiftMaster, Link Control, Sears Craftsman, Master Mechanic, Raynor, Steel Craft, True Value brand, please refer to the programming method of Chamberlain.  
7. Press the program button once to exit the configuration steps. You can use the configured button to control your door now. If your door does not response, please reconfigure the button once more. If it still fails, please contact us for further help.

Warranty

This remote carries a one-year manufactures warranty against defects in workmanship or materials commencing from the purchase date of the remote. If any problems occur, please contact us for help.